

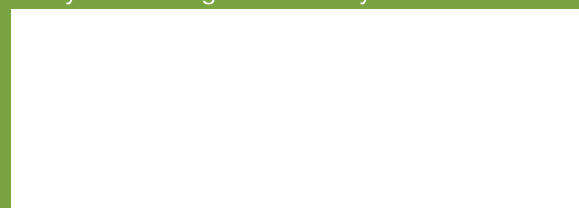

CREATING A BETTER FUTURE

 **LIUGONG / CARE**
1800 1033 852

Always a LiuGong dealer near you.



The LiuGong series of logos herein, including but not limited to word marks, device marks, letter of alphabet marks and combination marks, as the registered trademarks of Guangxi Liugong Group Co., Ltd. are used by Guangxi Liugong Machinery Co., Ltd. with legal permission, and shall not be used without permission. Specifications and designs are subject to change without notice. Machines shown may include optional equipment and may not include all standard equipment.



Corporate Office:
101, Okhla Phase III, New Delhi- 110020, Tel: 011-47272200
india@liugong.com

Manufacturing Plant:
Plot No. 163, Industrial Area, Sector-III, Pithampur
Dist.- Dhar, Madhya Pradesh- 454774, Tel: 07292-416700

www.liugong.com

Like and follow us:



11/2024 LIPL



E SERIES ELECTRIC REACH STACKER



SAFE AND RELIABLE SMART AND EFFICIENT
ENERGY-SAVING AND ENVIRONMENT FREINDLY
COMFORT AND CONVENIENCE

Battery Type	Lithium Iron Phosphate
Rated Storage Energy	525 Kwh
Operating Weight	73000 Kg
Rated Carrying Capacity	45000 Kg
Maximum Lifting Height	15100 mm
Torque (Rated/Peak)	1500/4200 Nm

LRSE4531E

ELECTRIC REACH STACKER

TOUGH WORLD. TOUGH EQUIPMENT.

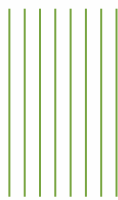

SAFETY AND RELIABILITY



LEADING BRAND CORE ELECTRIC COMPONENTS, HIGH RELIABILITY

- Hydraulic motor and drive motor are independently controlled
- Powerful (PMSM) permanent magnet synchronization motors
- CATL big capacity Lithium Iron phosphate battery, reliable and durable

INTELLIGENT THERMAL MANAGEMENT SYSTEM

- Ensure the machine can work under high temperature and low temperature conditions
- Motors, controllers and battery have cooling system
- Lithium battery low-temperature automatic heating function

OPTIMIZED STEERING AXLE ANGLE DEVIATION

- Deviation reduced by 90%
- Improved steering stability and extended tires life

FORCE ANALYSIS AND OPTIMIZATION OF STRUCTURAL COMPONENTS

LiuGong National Laboratory analyzed and improved the design of product structural components, ensure product strength is suitable for extreme working conditions

SAFE AND RELIABLE

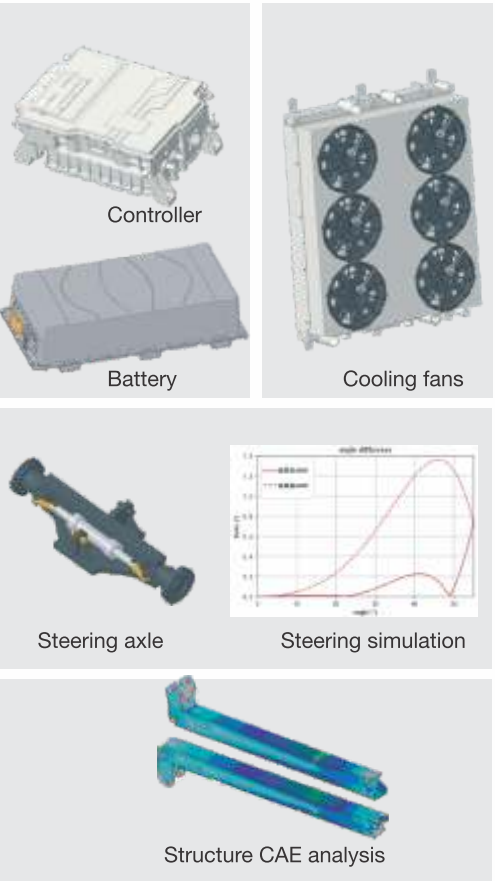

SAFE AND RELIABLE

AUTOMATIC FIRE SUPPRESSION SYSTEM:

Sensor located around the battery detects temperature and smoke, activates the alarm, and automates the fire extinguishing system to protect the driver and the machine.

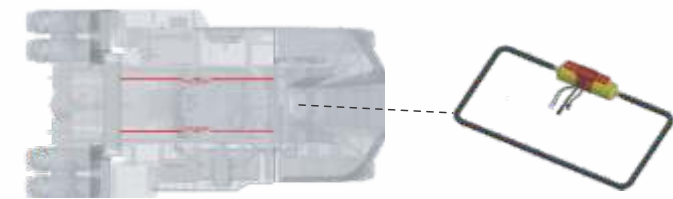

HIGH VOLTAGE INTERLOCK, INSULATION DETECT, GROUNDING PROTECT:

- High Voltage Interlock: High voltage cannot output until the entire high voltage circuit is connected properly.
- Insulation Detection: If there is current leakage, the system can automatically cut off the high voltage.
- Ground Protection: The battery ground connects with the frame to avoid electric shock.

SAFETY ACTIVE SYSTEM:

Detect staff and other objects. When interference occurs in the alarm zone, the safety system activates and the automatic brake engages

ROLLER PROTECT:

3 levels protect function:

- Levels 1 alarm by text;
- Levels 2 alarm by text and sound;
- Levels 3 Lift/down function is locked, release by manual bypass valve;
- Container sit protection function:
- Container can not lift unless 4 pin lock are closed

SELF DIAGNOSIS:

When faults occur, the system automatically diagnoses the issue, and an error code is displayed on the instrument panel.



LIUGONG HAS ESTABLISHED STRONG PARTNERSHIPS

World-renowned parts manufacturers, leveraging over 66 years of experience to produce professional machinery designed for tough conditions

SMART AND EFFICIENT

CLEAR AND EASY DISPLAY DATA,INTELLIGENCE MANAGER SYSTEM:

360° video and intelligent display show the state of the machine. The phone app can help you manage the equipment conveniently.



ELECTRICAL CONTROL POSITIVE FLOW HYD SYSTEM:

The electrical control hydraulic (HYD) system responds quickly and automatically adjusts according to requirements. It is highly sensitive and energy-efficient

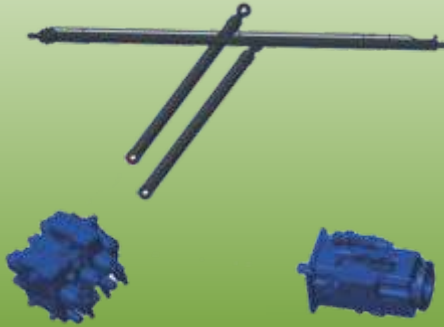

ELECTRICAL MOTOR DRIVE, HIGH EFFICIENCY:

The electrical motor connects directly to the drive axle and the hydraulic (HYD) pump, increasing efficiency by 10%

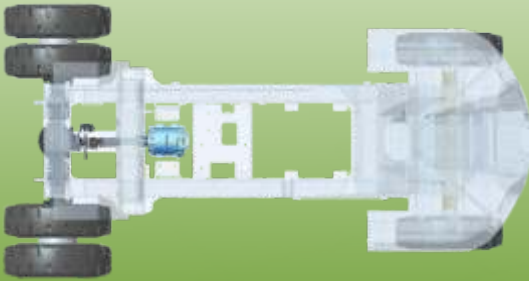

SMART AND EFFICIENT

VERTICAL LIFT TECHNOLOGY:

Based on calculation of container angle and weight,vertical lift button can active boom extend and cooperate well, keep the container vertical lift, increase lift efficiency in lifting-over containers and railway condition.

SELF ADJUST DAMPING TECHNOLOGY:

When handling empty container,spreader can adjust flat quickly, increase work efficiency, when travel with loaded container, it can reduce sway,to protect the load.



ENERGY CONSERVATION AND ENVIRONMENTAL FRIENDLY

ENERGY CONSERVATION AND ENVIRONMENTAL FRIENDLY



- **ELECTRIC POWER** : Green and environmentally friendly with zero emissions
- **POTENTIAL ENERGY AND BRAKING ENERGY REGENERATION**
Energy savings increased by 80%
- **LOW OPERATION COST** : 5-year total cost of ownership (TCO) Reduced by 80% compared to internal combustion
- **HYDRAULIC DEFOAMING TECHNOLOGY** : Defoaming rate reaches 95%, increasing the hydraulic oil replacement interval by 2 Times, which prolongs the life of the oil and hydraulic Components, and reduces maintenance costs

DEFOAMING RATE 50%

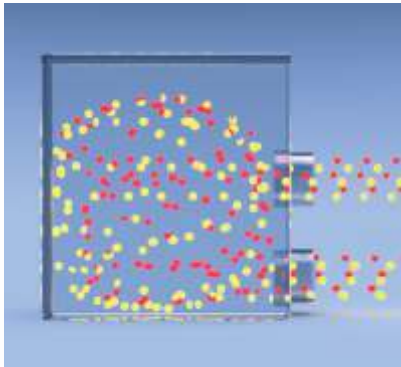

NON DEFOAMING SYSTEM

DEFOAMING RATE 95%

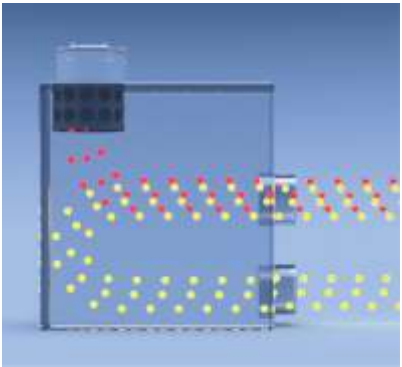

DEFOAMING SYSTEM

TOUGH WORLD. TOUGH EQUIPMENT.

TOUGH WORLD. TOUGH EQUIPMENT.

COMFORT AND CONVENIENCE



ELECTRICAL POWERED SLIDING CAB:

LiuGong patent technology, 24V motor for cab drive, the moving can be operated from inside or out side of cab.

PRESSURE CAB:

Suspension cab equipped with wide - angle visibility, noise reduction technology, air conditioning, an auxiliary seat, a movable operator arm, and a seat with a large adjustable angle range.

COMFORT AND CONVENIENCE

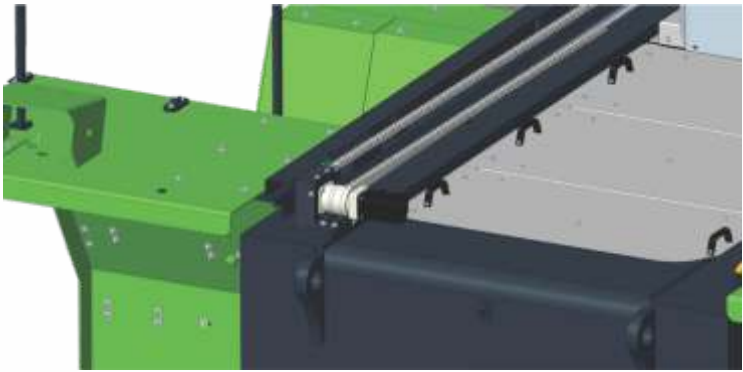

ELECTRICAL POWERED SLIDING CAB

ALL-ROUND LIGHTING:

Front, rear, boom, and spreader are equipped with working lights.



CONVENIENT MAINTENANCE & EASY SERVICE:

Core part such as motors, battery can be maintained easily, the radiator fan can reverse direction to blow out dust and debris, helping to keep the cooling system clean and efficient.

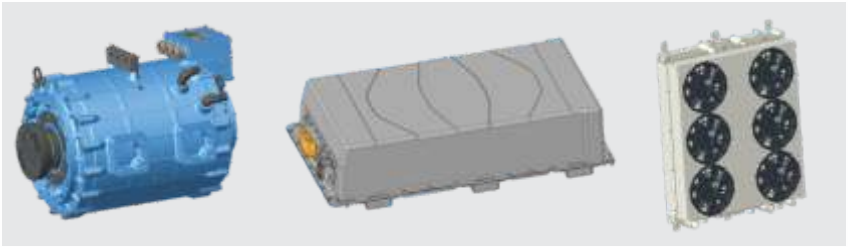

SPECIFICATIONS

Battery	
Battery Type	Lithium Ion
Voltage	580 V
Capacity	525 kWh, 423kWh (Optional)
Charging Time	1.8 h
Battery Running Time	10 h
Protection Grade	IP68
Other Function	Heating, Water cooling
Motor	
Drive Motor Type	Permanent Magnet Synchronization (PMSM)
Work Class	S9
Power (rated/peak)	157/310 kW
Torque (rated/peak)	1500/4200 N.m
Speed (rated/peak)	1000/2800 r/min
Cooling Method	Independent Water Cooling
Protection Degree	IP67
Axle	
Drive Axle Model	Kessler
Spreader	
Model	LDJ450
Side Shift	±800 mm
Rotating Angle	+105°/-195°
Tilt Angle	±2°
Weight	8.1T
Suitable Container	ISO 20ft/40ft/45ft
Tire	
Size	18.00-25 40PR

Technology Parameter	
Boom Max. Lifting Height	15100mm
Boom Tilt	0-60°
Max. Lifting Speed (unladen/laden)	420/250 mm/s
Max. Lower Speed (unladen/laden)	360/300 mm/s
Max. Travel Speed (unladen/laden)	21/15 km/h
Gradeability (unladen/laden)	21/14 %
Operation Weight	73000 Kg
Rated Capacity	45000 Kg
Stacking Layers	5
Overall Length L	11311 mm
Wheelbase L1	6000 mm
Overall Height H	4777 mm
Minimum Ground Clearance	350 mm
Overall Width W	6053-12185mm
Front Wheel Tread T1	3033 mm
Rear Wheel Tread T2	2798 mm
Minimum Turning Radius R	8000 mm
20ft Container Aisle Width A1	11300 mm
40ft Container Aisle Width A2	13600 mm

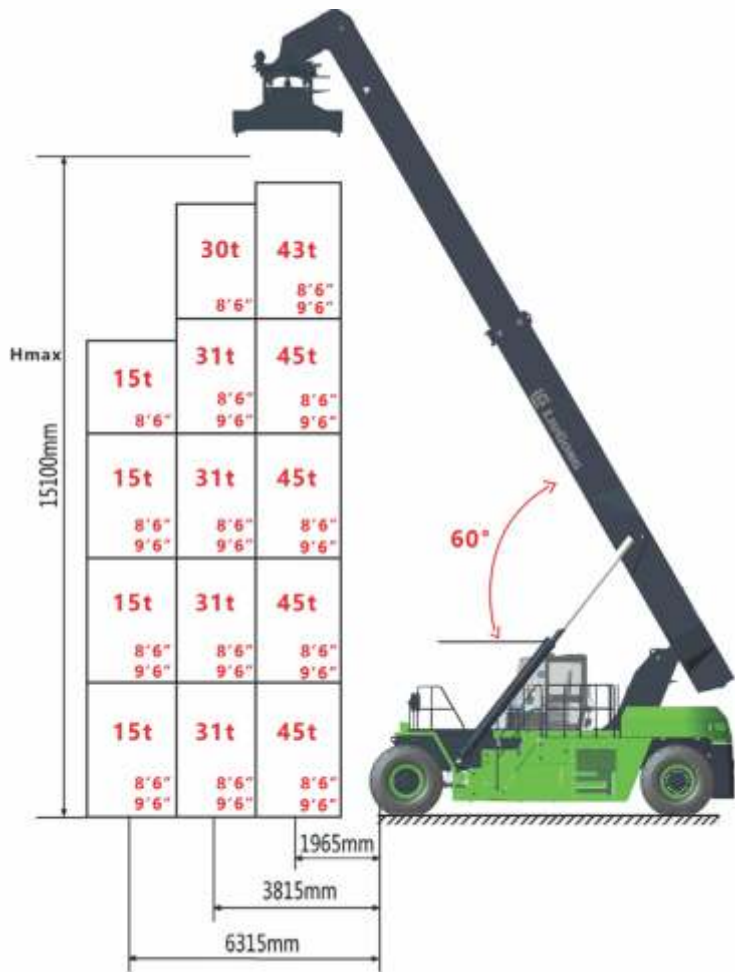
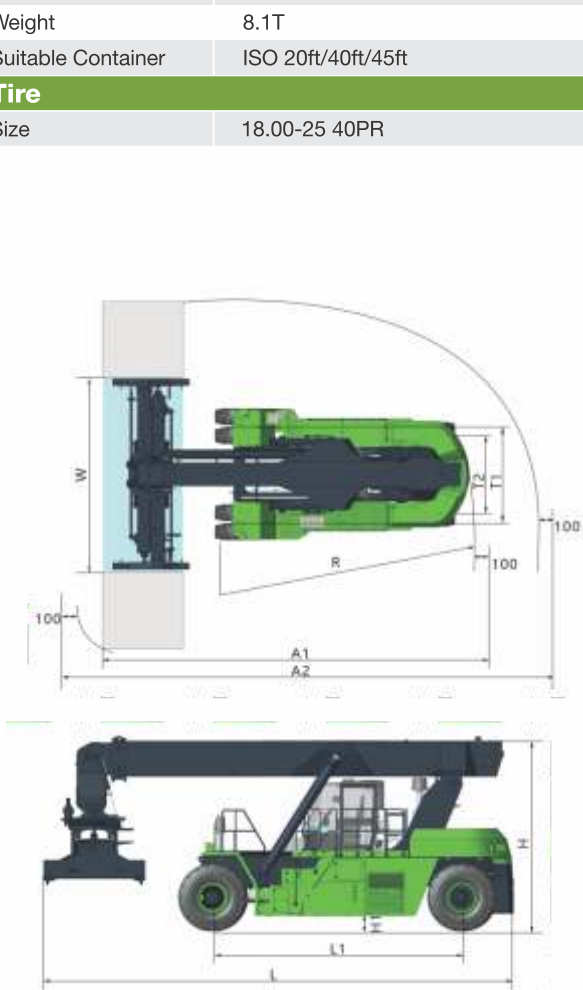

Standard / Optional

Auto active safety system	●	System pressure monitor	●
Anti rollover protection	●	Self diagnosis function	●
Heavy load speed limit	●	Lock position monitor	●
Automatic fire extinguishing system	●	Rotary lock counting	●
Adaptive electronic damping technology	●	Automatic lock container	●
OPS system	●	Electric control movable cab	●
Vertical lift function	●	AC system	●
Fast lift function	●	Spreader indicator light	●
Weighing system	●	Additional seat	●
Fleet management system	●	Cab reading light	●
Braking regeneration function	●	Reverse image/radar	●
Battery heating function	●	Working headlights on cab top	●
Cooling system	●	360 ° panoramic image	●
CAN-BUS	●	Voice control system	●
Optional attachments	○	Import spreader	○
Tires pressure monitor function	○	Centralized lubrication	○
HYD oil heating function	○	Spreader camera monitoring system	○
Off load weighing system (railway specific)	○		

● Standard ○ Optional

Standard



Optional

